



Th. WORTELBOER B.V.

P.O BOX 5 - NL - 6580 AA MALDEN
HOLLAND

PHONE 31 - 24 - 358 65 14

FAX 31 - 24 - 358 70 79

www.wortelboer.ws

E-mail : info@wortelboer.ws

High pressure powerpack

Max. testing up to 3660 bar / 52.200 PSI



The portable powerpack DPS / WPS is a well-proven self-contained and air driven unit, designed to pressurize valves, hoses, piping vessels, safety valves and wellhead equipment. It can also be used to provide hydraulic power for operating such components as cylinders, presses, rams, jacks, bolt tensioners and actuators.

- Model DPS operates from an integral reservoir

- Model WPS operates with a direct water feed which can be connected to a mains water supply

Both units are available in 10 pressure ranges as standard in either a single-acting or double-acting pump configuration. In addition, the units are available with a chart recorder. The resultant chart may be used as a test certificate.

Operation

Output-pressure control is achieved by regulating the air-supply pressure, using the air regulator provided. When the desired pressure is reached, the air-driven pump will automatically stop, thus requiring no power to maintain the pressure. The output pressure is indicated by the test gauge and recorder (option). Pressure is released by operating the bleed valve. The test media employed can be water, oil or an emulsion of both.

WPS/DPS	Model	Max. output pressure		Flow (ltr/min)		Indicator ranges	
		bar	psi	(1)	(2)	B (bar)	P (psi)
WPS / DPS 160	10	70	1.025	26,3	50,0	0-100	0-1.500
WPS / DPS 160	20	145	2.100	13,2	25,0	0-200	0-3.000
WPS / DPS 160	30	200	2.850	9,5	18,0	0-275	0-4.000
WPS / DPS 160	40	285	4.100	6,4	12,2	0-410	0-6.000
WPS / DPS 160	65	450	6.400	4,2	8,0	0-690	0-10.000
WPS / DPS 160	115	795	11.400	2,4	4,5	0-1030	0-15.000
WPS / DPS 160	180	1.240	17.800	1,5	2,9	0-1720	0-25.000
WPS / DPS 160	255	1.790	25.600	1,1	2,1	0-2410	0-35.000
WPS / DPS 160	400	2.800	40.000	0,7	1,3	0-3790	0-55.000
WPS / DPS 160	520	3.660	52.200	0,5	0,9	0-5000	0-70.000
WPS / DPS 200	30	230	3.375	11,0	21,0	0-340	0-5.000
WPS / DPS 200	45	310	4.450	7,8	15,0	0-410	0-6.000
WPS / DPS 200	65	450	6.400	5,4	10,5	0-690	0-10.000
WPS / DPS 200	100	700	10.000	3,5	6,6	0-1030	0-15.000
WPS / DPS 200	180	1.240	17.800	1,9	3,7	0-1720	0-25.000
WPS / DPS 200	280	1.940	27.800	1,2	2,4	0-2750	0-40.000
WPS / DPS 200	400	2.800	40.000	0,9	1,6	0-5000	0-55.000
DPS= with 17 liter reservoir WPS= with direct water feed	The type of the unit indicates the pump ratio and thus the output pressure, based on 7 bar air pressure.	1= single acting pump 2= double acting pump		High pressure connection: 3/4"-16 UNF female (FU2) Air connection: 1/2" BSP-female. (Minimum 8-10 bar / 115 psi - 145 psi) Direct water connection: 1/2" BSP-female (Only with WPS)			

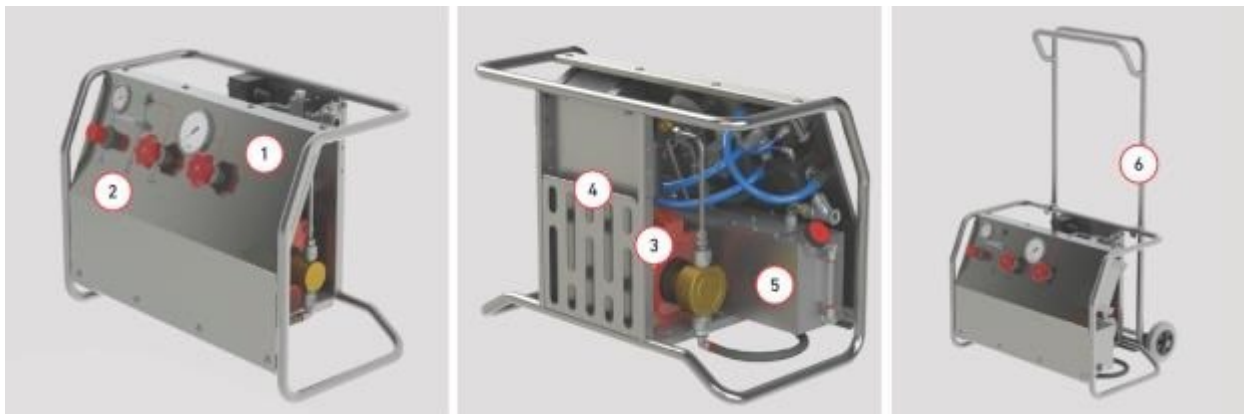

1. Control unit
2. High pressure outlet
3. Ground connection
4. Document holder
5. 17 liter tank (optional)
6. Removeable transport unit with wheels (optional)